



## Neighborhood House Tour

Modernism Week • 2016

# Welcome to Twin Palms



***William Krisel, A.I.A.***

In 1956, developers George and Robert Alexander, working with architect William Krisel completed the Ocotillo Lodge at the southern edge of Palm Springs. The Lodge welcomed home-seekers considering one of their 90 new and distinctive residences. 'Distinctive' because this fledgling district (referred to then as "Smoke Tree Valley Estates") introduced to the desert such modernist elements as open carports, clerestory windows, exposed concrete block, breezeways, and butterfly roofs. With little fanfare at the time, the area became both the first mid century modern neighborhood completed by the Alexander Construction Company and the first truly modern housing tract in Palm Springs.

Only two floor plans were available from which prospective Twin Palms homeowners could choose. But a wide variety of available facades, roof-lines, landscaping, color palettes, and home orientations on the property effectively concealed this limitation. The result is that the Alexanders could pass along to buyers the economies of constructing tract housing, and buyers could enjoy a sense of owning a home that was aesthetically unique — at least on the outside.

As a design and marketing strategy, this proved quite sound. Considered for decades to be a second hometown for the wealthy, Palm Springs suddenly came within grasp of a much larger population of home buyers. The 90 original residences sold briskly and led to the development of equally popular tracts elsewhere in the area. In this way, the success of Twin Palms initiated the City's first major housing boom and forever changed its architectural landscape.

Today, exactly 60 years later, Twin Palms enjoys a population mix that reflects the diversity and spirit of Palm Springs. The legacy of William Krisel and the Alexanders is a neighborhood alive with history, rich with character, and fully engaged in its affairs both social and civic.

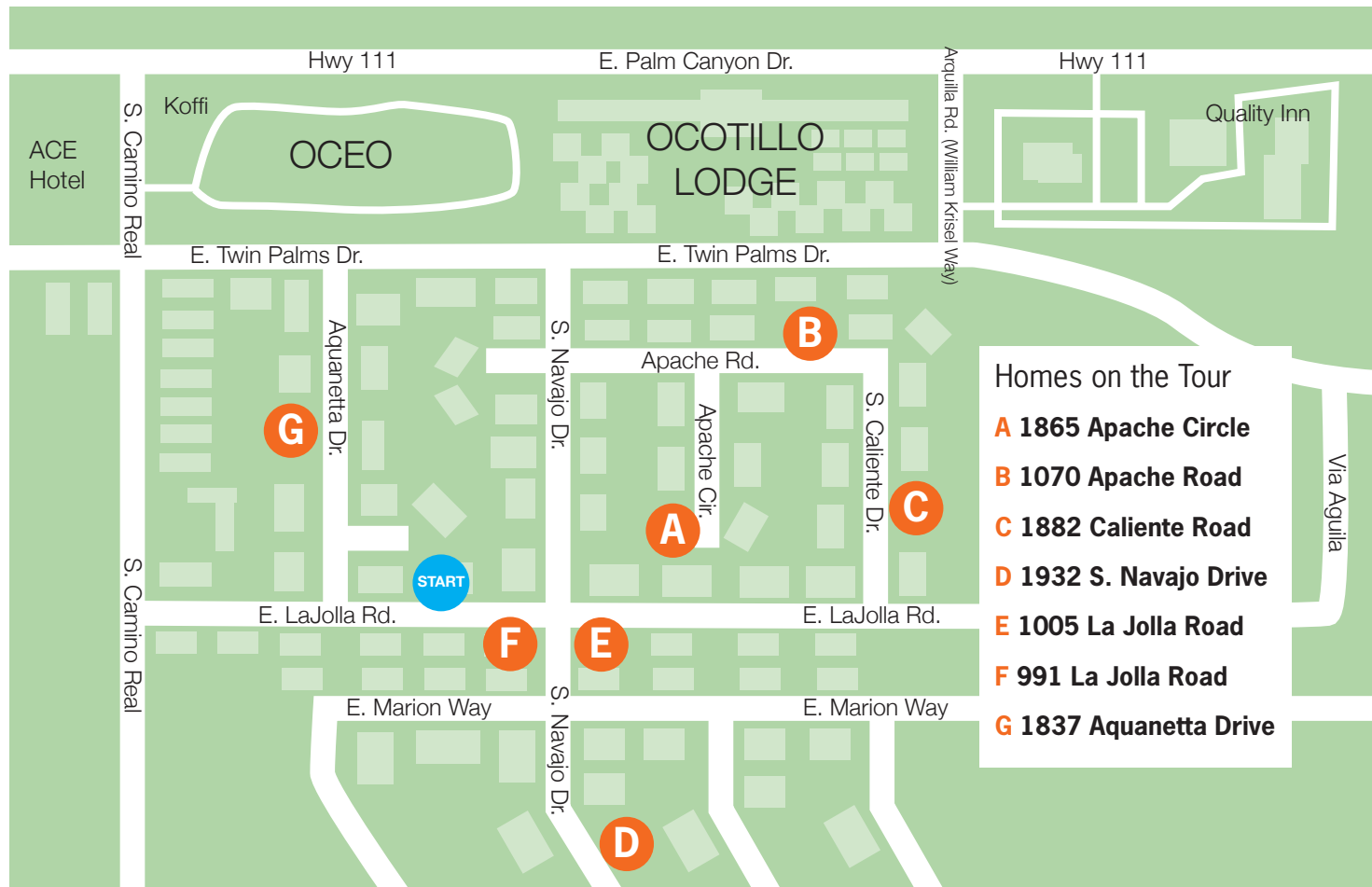



**A**

**1865  
Apache  
Circle**

With its iconic butterfly roofline, post and beam construction and original Tectum exterior panels, this home is emblematic of William Krisel's simple yet sophisticated mid century desert architecture.

The current owners have brought their interior design expertise to update the house for contemporary living, while staying true to the spirit of the period. Teak cabinetry and paneling, terrazzo tile floors, custom furniture and vintage lighting lend to this light-filled house a warmth and gracious ease.





**B**  
**1070**  
**Apache**  
**Road**

I fell in love with this home the minute I saw it in 1999. It just had a feeling of exuberance and happiness with those outstretched wings of the roofline. It is bright and airy inside and offers just the right glimpses of the sky, mountains and palms. You are always connected to the outdoors here. In 2006 I worked with the original architect, William Krisel, to restore and renovate the home. My goal was to restore authentically and as close to the original look as possible. I wanted it to look as it was presented to the buying public in 1957 when it was first finished. In addition, Mr. Krisel designed a landscape plan for me that works so well with the feeling of the house.



**C**  
**1882**  
**Caliente**  
**Road**

My house is described as a flat roof, model A-3 tract home designed by the architect William Krisel and constructed by the Alexander Construction Company in 1957. In 2012, it was restored with the full involvement of the original architect. He redesigned the sun flaps to allow for more light and updated the landscaping to include indigenous plants and eco-friendly, recycled rubber mulch. Paint colours that Krisel created in 1957 were also reintroduced including “Weathered Brown” for the ceiling beams. The deceptively simple design, abundance of light, flow of air and the relationship between the inside and outside captivated me immediately and I feel very fortunate to be able to call this house my home.





**D**  
**1932**  
**S. Navajo**  
**Drive**

Our home is a model A-1 extended butterfly roof built in 1958. We love the mid-century modern aesthetic and everything this house embodies, especially the walls of glass and clerestory windows that showcase the beautiful views of the mountains and allow for a seamless flow between the indoors and out. By opening the kitchen, we wanted to extend the openness of the home and maximize the soaring roofline.



**E**  
**1005**  
**La Jolla**  
**Road**

Ever since I transplanted from New York to the West Coast I dreamed of having a getaway spot in the desert. When we walked into our Krisel Alexander home, our family knew immediately that this was the one. The simple clean lines created an empty exhibition space within which I felt we could explore real concepts of modern living, connected to the rich history of the place, but almost more relevant now with the total immersion of technology into our lives. The large windows filled the rooms with natural, not digital light, and the simplicity was so sleek and smart. The luxury in this special place for us is about its simplicity; it was love at first sight.





**F**  
**991**  
**La Jolla**  
**Road**

I had always wanted to live in an architecturally significant house. What struck me first was the “body” of the butterfly. The soaring space provides a more formal area of my home, allowing me to showcase my art and Broyhill Brasilia furniture. My desire was to make changes to the house that provided for my 21st century needs while honoring the architectural heritage of the house. Blending the past with the future works for me.





**G**  
**1837**  
**Aquanetta**  
**Drive**

Prime example of the Alexander Construction Company, Palmer-Krisel Architects 1957 modern home with its rare and iconic butterfly roofline located in the historic, mid century Twin Palms. It has undergone an extensive metamorphosis by Architectural designer Markus Canter. He and his wife have for many years had an affectionate eye on this desert property. They had long admired its peaceful Palm Springs location, intimate quiet street, the home's soaring ceilings and walls of glass showcasing endless views of the San Jacinto Mountains prior to purchasing the property as a home for their family and friends to connect, reflect, and relax.

One of the floorplan options as rendered by the Palmer & Krisel office in 1957

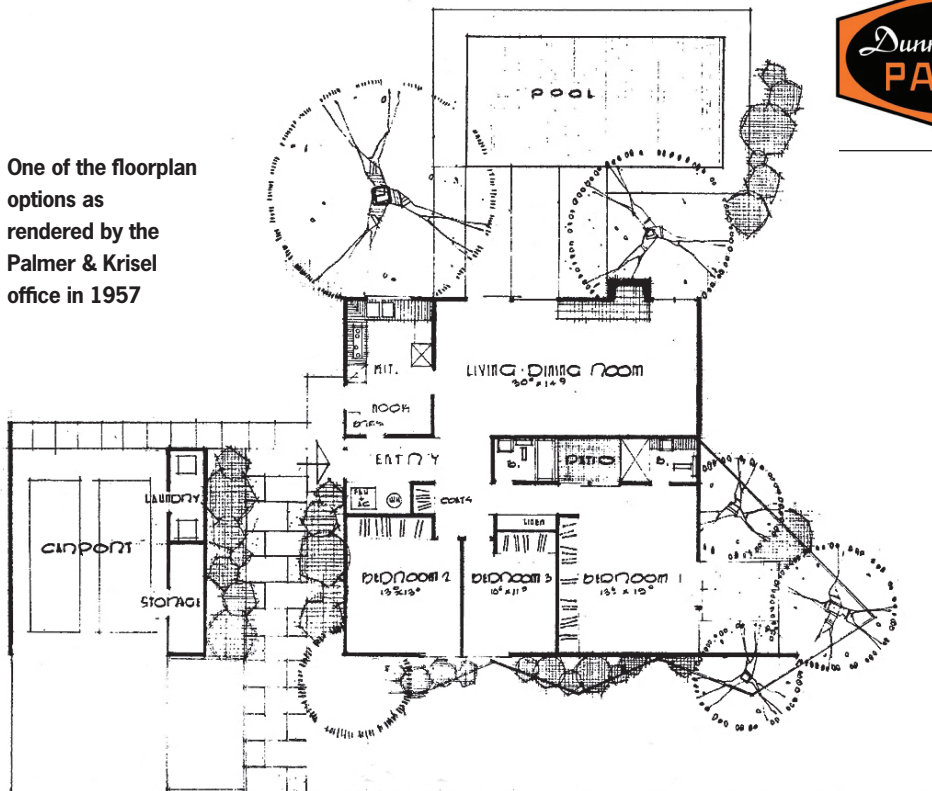

Special Thanks to:



**modernism week**

Official Modernism Week Event

**Thank you to the following.**

Without your talent, support and dedication our tour would not be possible.

**Photography:** CLARK DUGGER

**Graphic Design:** HENRY CONNELL

**Tour Homeowners:**

MERAH and CHRIS BONDS

COREY LYNN CALTER

MARKUS CANTER and CRISTIE ST. JAMES

HEIDI CREIGHTON

STEVEN LEWIS

CHRIS MENRAD

DEBORAH RUMENS

**Modernism Committee members:**

STEVEN LEWIS

MICHELE JOHNSON

STAN and JAN SARTOR

DAVID WILLIAMSON

**and to our**

**Twin Palms Volunteers**



Please join us for the  
Dedication Ceremony for

# William Krisel Way

10 AM Tuesday February 16, 2016

At the corner of Twin Palms Drive and  
Arquilla Road

